

**vtech**<sup>®</sup>

User's Manual

# Touch & Teach Word Book™

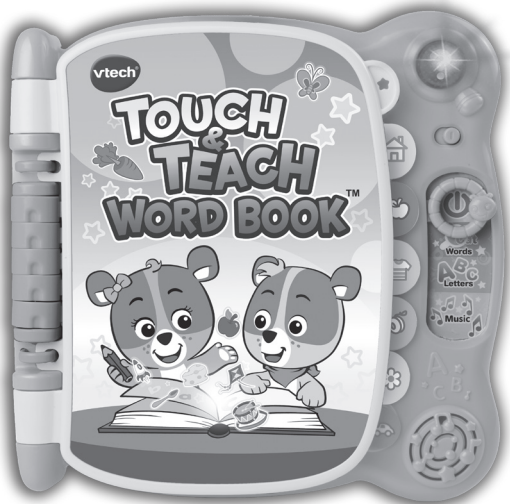

© 2013 VTech  
**Printed in China**  
91-009645-000 US  

Dear Parent,

At **VTech**<sup>®</sup>, we know how important the first day of school is for your child. To help prepare preschoolers for this important event, **VTech**<sup>®</sup> has developed the **Preschool Learning**<sup>™</sup> series of interactive toys.

**Preschool Learning**<sup>™</sup> features fun characters and inviting school themes that use technology to capture a child's attention and teach important preschool skills like spelling, counting and the alphabet. These vital skills are taught in a way that's both fun and highly engaging to maintain a child's interest. Children will also be introduced to fun school subjects such as art class, music class and even recess! With **Preschool Learning**<sup>™</sup>, learning is fun from day one!

At **VTech**<sup>®</sup>, we know that a child has the ability to do great things. That's why all of our electronic learning products are uniquely designed to develop a child's mind and allow them to learn to the best of their ability. We thank you for trusting **VTech**<sup>®</sup> with the important job of helping your child learn and grow!

Sincerely,

Your friends at **VTech**<sup>®</sup>

To learn more about **Preschool Learning**<sup>™</sup> series and other **VTech**<sup>®</sup> toys, visit [www.vtechkids.com](http://www.vtechkids.com)

# INTRODUCTION

Thank you for purchasing the **VTech® Touch & Teach Word Book™**! Discover the magic of words with the **Touch & Teach Word Book™** by **VTech®**! Cody the Smart Cub™ and Cora the Smart Cub™ will help your child learn letters and more than 100 words in four different activities. Twelve interactive pages come to life with the touch of a finger.

VOLUME SWITCH GAME BUTTON

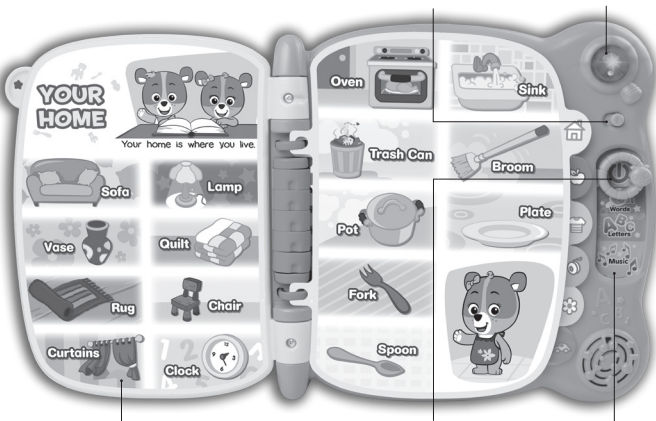

12 INTERACTIVE PAGES

ON / OFF /  
MODE SELECTOR

THREE  
MODES

INTRODUCTION

# INCLUDED IN THIS PACKAGE

- One VTech® Touch & Teach Word Book™
- One User's Manual

## WARNING:

All packing materials, such as tape, plastic sheets, packaging locks and tags are not part of this toy, and should be discarded for your child's safety.

## ATTENTION

Pour la sécurité de votre enfant, débarrassez-vous de tous les produits d'emballage tels que rubans adhésifs, feuilles de plastique, attaches et étiquettes. Ils ne font pas partie du jouet.

**NOTE:** Please keep instruction manual as it contains important information.

Unlock the packaging locks:

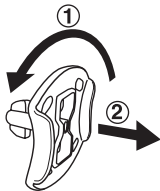

- ① Rotate the packaging lock counter-clockwise 90 degrees.
- ② Pull out the packaging lock.

# GETTING STARTED

## BATTERY INSTALLATION

1. Make sure the unit is turned **OFF**.
2. Locate the battery cover on the bottom of the unit. Use a screwdriver or coin to loosen the screw.
3. Install 2 new “AA” size (LR6/AM-3) batteries following the diagram inside the battery box. (The use of new alkaline batteries is recommended for maximum performance.)
4. Replace the battery cover and tighten the screw to secure.

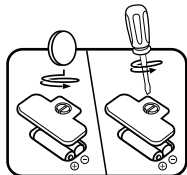

## BATTERY NOTICE

- Use new alkaline batteries for maximum performance.
- Use only batteries of the same or equivalent type as recommended.
- Do not mix different types of batteries: alkaline, standard (carbon-zinc) or rechargeable (Ni-Cd, Ni-MH), or new and used batteries.
- Do not use damaged batteries.
- Insert batteries with the correct polarity.
- Do not short-circuit the battery terminals.
- Remove exhausted batteries from the toy.
- Remove batteries during long periods of non-use.
- Do not dispose of batteries in fire.
- Do not charge non-rechargeable batteries.
- Remove rechargeable batteries from the toy before charging (if removable).
- Rechargeable batteries are only to be charged under adult supervision.

# PRODUCT FEATURES

## 1. ON / OFF / MODE SELECTOR

Slide the **MODE SELECTOR** to one of the activity icons to turn the unit **ON**. Slide the **MODE SELECTOR** to the top of the mode selector panel to turn the unit **OFF**.

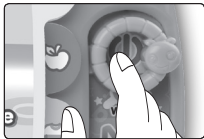

## 2. THREE MODES

Slide the **MODE SELECTOR** to choose one of **THREE MODES**. Your child can explore words, letters and music!



## 3. 12 INTERACTIVE PAGES

Turn to any of the **12 INTERACTIVE PAGES** and simply touch to explore and learn.



## 4. GAME BUTTON

Press the **GAME BUTTON** to play the **Find It!** quiz game. The LED light flashes when a question is given or when the player gives a correct answer.



## 5. VOLUME SWITCH

Slide the **VOLUME SWITCH** to select a high or low volume setting.



## 6. AUTOMATIC SHUT-OFF

To preserve battery life, the **VTech® Touch & Teach Word Book™** will automatically turn off after a few minutes without input. The unit can be turned on again by sliding the **MODE SELECTOR**, turning the **INTERACTIVE PAGES** or pressing the **GAME BUTTON**.

## HOW TO PLAY

To get the most from your **Touch & Teach Word Book™**, follow these simple instructions:

1. When playing, make sure the book is fully open. The pages should lay flat against the front and back panels of the book.
2. For optimal performance, use one finger when touching the pages.



## INCORRECT OPERATION

To ensure proper touch responses, avoid the following actions when playing with your **Touch & Teach Word Book™**:

1. Do not touch a picture if the pages are not laying down flat.



2. Do not touch more than one picture at a time.
3. Do not use more than one finger to touch a picture on the page. Avoid resting your hand on the page.



## ACTIVITIES

### 1. What's That Word?

Touch the pictures to learn about words and objects related to your home, food, clothes, toys, the park and the zoo.

Touch the category section on the left page or the bear section on the right page to hear more fun phrases and words.

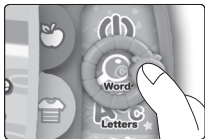

### 2. Letter Fun

Touch the pictures to learn about the first letters of words.

If you touch all of the objects in one category before turning the page, you'll hear a bonus song that teaches the alphabet!

Touch the category section on the left page or the bear section on the right page to hear more fun phrases and words.





### 3. Music Time

Touch the category section on the left page or the bear section on the right page to choose a melody. Touch the words to add some fun sounds while the melody is playing.

For added fun, you'll sometimes hear a bonus song that teaches the alphabet. You can interrupt the song with fun sounds by touching the pages.



### 4. Find It!

Listen to the questions and touch the answers to play a fun quiz game to see what you've learned.

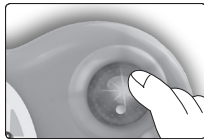

## MELODY & SONG LIST

1. The Farmer in the Dell
2. The Animal Fair
3. Old MacDonald Had a Farm
4. Frère Jacques
5. This Old Man
6. Hickory Dickory Dock
7. London Bridge
8. Twinkle, Twinkle Little Star
9. Chopsticks
10. Hot Cross Buns
11. One, Two, Buckle My Shoe
12. Three Little Kittens
13. Alouette
14. Can Can
15. Pop! Goes the Weasel
16. The Alphabet Song

# CARE & MAINTENANCE

1. Keep the unit clean by wiping it with a slightly damp cloth.
2. Keep the unit out of direct sunlight and away from any direct heat source.
3. Remove the batteries when the unit is not in use for an extended period of time.
4. Do not drop the unit on hard surfaces and do not expose the unit to moisture or water.
5. Make sure the book pages are kept dry and flat.

# TROUBLESHOOTING

If for some reason the program/activity stops working or malfunctions, please follow these steps:

1. Turn the unit **OFF**.
2. Interrupt the power supply by removing the batteries.
3. Let the unit stand for a few minutes, then replace the batteries.
4. Turn the unit back **ON**. The unit will now be ready to play again.
5. If the product still does not work, replace with a new set of batteries.

If the problem persists, please call our Consumer Services Department at 1-800-521-2010 in the U.S., or 1-877-352-8697 in Canada, and a service representative will be happy to help you.

For information on this product warranty, please call **VTech®** at 1-800-521-2010 in the U.S. or 1-877-352-8697 in Canada.

## **IMPORTANT NOTE:**

Creating and developing **VTech® Preschool Learning** products is accompanied by a responsibility that we at **VTech®** take very seriously. We make every effort to ensure the accuracy of the information, which forms the value of our products. However, errors sometimes can occur. It is important for you to know that we stand behind our products and encourage you to call our Consumer Services Department at 1-800-521-2010 in the U.S., or 1-877-352-8697 in Canada, with any problems and/or suggestions that you might have. A service representative will be happy to help you.

## **Note:**

This equipment has been tested and found to comply with the limits for a Class B digital device, pursuant to Part 15 of the FCC Rules. These limits are designed to provide reasonable protection against harmful interference in a residential installation. This equipment generates, uses and can radiate radio frequency energy and, if not installed and used in accordance with the instructions, may cause harmful interference to radio communications. However, there is no guarantee that interference will not occur in a particular installation. If this equipment does cause harmful interference to radio or television reception, which can be determined by turning the equipment off and on, the user is encouraged to try to correct the interference by one or more of the following measures:

- Reorient or relocate the receiving antenna.
- Increase the separation between the equipment and receiver.
- Connect the equipment into an outlet on a circuit different from that to which the receiver is connected.
- Consult the dealer or an experienced radio/TV technician for help.

**Caution:** Changes or modifications not expressly approved by the party responsible for compliance could void the user's authority to operate the equipment.



CLASS 1  
LED PRODUCT